

NATURA™

Cut-To-Fit Accordion Flange

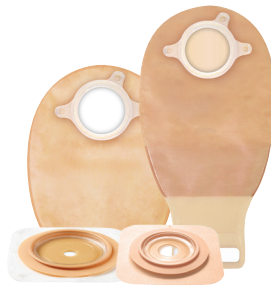

ACCORDION FLANGE APPLICATION

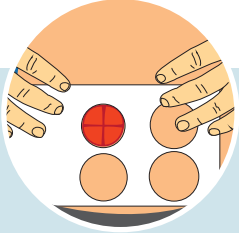

1. Measure the stoma and select the appropriate size skin barrier.



2. Trace the stoma size on the center of the white release paper on the reverse of the skin barrier, then cut an opening about 1/8" (3mm) larger than your tracing.

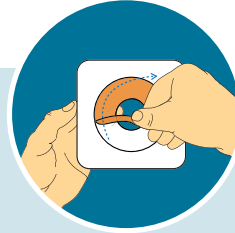

3. Peel off clear release liner from the back side of the wafer and position the circular opening over your stoma. Skin should be clean and dry.

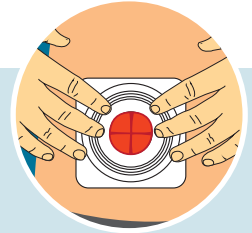

4. Remove white release paper and press against the skin. Smooth the tape collar and hold the barrier in place for 30 seconds.

APPLYING AND WEARING THE POUCH

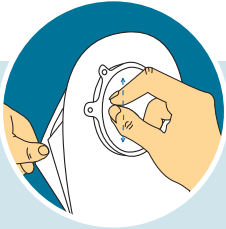

1. Separate the sides of the pouch to allow some air to enter.

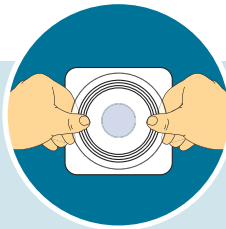

2. **PULL UP** accordion flange and hold with thumbs on top and fingers underneath. Align flanges of pouch and skin barrier.

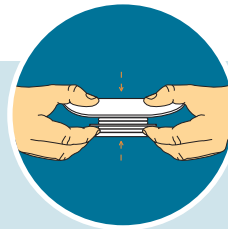

3. Start at the bottom and apply pressure around the flanges of the pouch and barrier, until they are **COMPLETELY** snapped together all the way around. Then place the accordion flange in the **DOWN** position for a flat profile.

CLOSING THE POUCH

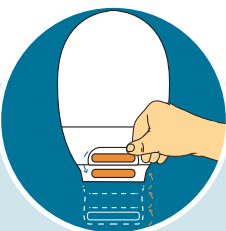

1. Fold the end up towards you until the interlocking closures line up. Press and pinch firmly across the entire length of the closure to secure.



2. Turn the Lock-it-Pocket™ inside-out to tuck tail inside.

EMPTYING AND CLEANING THE POUCH



1. To empty pouch, tilt the tail up towards your body. Peel open the closure and unravel tail. Unlock pouch closure and open the tail by pushing in both ends of the outlet end-strips with fingers; drain pouch.



2. **Tips for cleaning the pouch:** Support the pouch with one hand and wipe the tail of the pouch in a firm downward motion with toilet tissue in your other hand.

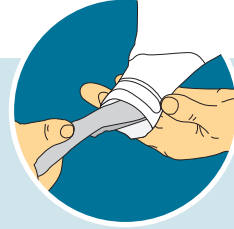

3. Clean in the inside surface of the tail with toilet tissue or wipe.

REMOVING THE POUCH



1. To remove the pouch from the flange, hold the flange down with one hand and gently un-snap the pouch.

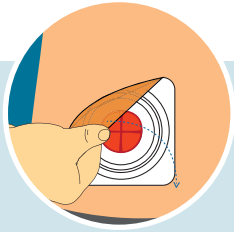

2. Gently pull the skin barrier down, away from the skin, while supporting the adjacent skin with your other hand.



More than just great products – me+™ brings you the tools and advice to help you make life with an ostomy completely your own.

me+ support is available by phone or email in whatever language you need.

Call us at 1-800-422-8811 (M-F, 8:30AM-7:00PM EST) or e-mail us at CIC@convatec.com

Visit our website www.convatec.com/ostomy

YOUR PRODUCT INFORMATION

Product Name: _____

SKU Number: _____ Quantity: _____

Notes: _____

